

# FVM-1000, RJ45 to SFP Managed Fast Ethernet Media Converter

## Product Images

---

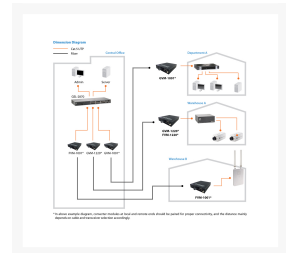

## Short Description

---

- Transfers data from 10/100Base-TX copper to fiber interfaces
- Supports Operations, Administration, and Maintenance (OAM) mechanisms
- Supports VLAN (tag-based, Q-in-Q)
- Web-based and SNMP Management
- Built-in LFP (Link Fault Pass-through) (LLCF/LLR) Technology
- IEEE 802.3x Flow Control protects against lost packets for reliable data transmission

## Description

---

FVM-1000 is remote Managed Fast Ethernet fiber media converter with OAM functions developed by our company. It can convert Ethernet signal between 10/100Base-Tx and

100Base-FX, It supports both half-duplex and full-duplex operations and a variety of fiber options.

Remote devices can be managed by fiber-connected OAM media converter or OAM switch when deployed as a stand-alone solution. It incorporates an easy to use Web user interface for operation, administration and maintenance, both locally and remotely. By offering IEEE802.3ah OAM compliance, this converter can be linked to any IEEE802.3ah compliant fiber switch and support loop back and dying gasp functions. All functions of this converter and the remotely connected converter can be configured and monitored via Web management, including bandwidth control, duplex, speed and VLAN configuration.

## Additional Information

Fast Ethernet RJ45	1
Fast Ethernet SFP	1
Harmonized System (HS) code.	851762
Customs product code (TARIC).	8517620000
Features.	1. 10/100Mbps auto-sensed, facilitating network upgrade 2. Support LFP function 3. Built-in efficient switching core to implement flow control and reduce broadcast packets 4. Full-duplex and half-duplex auto-sensed 5. Support Hop-swap SFP slot 6. Support Jumbo frame up to 9k bytes 7. Support Q-in-Q function, Optical port and Ethernet port can be set separately as dual Tag ports, and can be set as ISP Tag and ISP Tag TPID 8. Support configure the operation mode of each port on local and remote devices, including port speed, full/half-duplex, and flow control, etc, and can display the real-time status of each port 9. Support bandwidth-limiting function: with the step of 64kps, the bandwidth can be set between 0Mbps and 100Mbps 10. Support 4 kinds of 802.3ah OAM functions: Discover of OAM, MIB variable response, OAM Loopback, Dying Gasp alarm 11. Offer MIB library files, support OpenView?Snmpc, and other softwares
Fiber Optical Mode.	Both
Media Interface.	RJ45 to SFP
PoE Supported.	No
Manageable.	Yes
Grade.	Commercial
Dimensions (W x D x H).	127 x 156 x 32 mm
Product weight (kg).	0,7
Data Rate.	100Mbps
Indicators.	PWR (power supply), FX LINK/ACT (optical link action), FDX (full duplex), TX LINK/ACT (TP cable link/action), TX 100 (TP cable rate 100M), LFP(LFP function enable/disable)
MTBF.	30000hours

Power supply included.	Yes
Standard.	IEEE802.3 10Base-T Ethernet, IEEE802.3u 100Base-Tx Fast Ethernet, IEEE802.3u 100Base-Fx Fast Ethernet, IEEE802.3x Flow Control, IEEE802.3ah OAM
Transmission Method.	store and forward or cut-through by software configure
Wavelength (nm).	Depend on SFP fiber optical transceiver
Operating humidity.	10% RH ~ 90% RH
Operating temperature.	-10°C ~ 55°C
Package Contents.	● FVM-1000 ● Power Cord ● Quick Installation Guide ● Declaration of Conformity
Color.	Black
EAN.	4015867195475
Model Number.	FVM-1000

